



MAXWORTH
Building Values in Real Estate

Availability, Affordability, Suitability...



AASHRAY
An Affordable Housing Project

An affordable group housing project under the Haryana Government Affordable Housing Policy, 2013.



Our attitude is to provide you the Most



Premier urban Sector 15-II, Gurugram



City residences Sector 10 A, Gurugram

Affordable, Available & Suitable...

The Government of Haryana introduced an Affordable Housing Policy in 2013 with the objective of providing most affordable houses. These apartments meet the realistic demand for most sought-after category of budget houses with all basic amenities for modern community living.

Maxworth Infrastructures Pvt. Ltd is real estate company performing silently since year 2010. The first group housing in Sector 15-II Gurugram (PREMIER URBAN) consisting of 168 apartments is already delivered and the second project in Sector 10A Gurugram (CITY RESIDENCES) is getting ready for delivery by September 2017.

Our projects display the our performance and a happy family of our most satisfied customers.

Maxworth in continuity with its objective of building values in real estate, is developing "AASHRAY" an Affordable Group Housing Project in Sector-89, Gurugram, located on Main Pataudi Road (State Highway) just 2 kms from Dwarka Expressway crossing.

AASHRAY is our affordable group housing Project with 766 units consisting of 1BHK, 2BHK and 2BHK (plus Study) apartments.

Our Attitude is to provide the most affordable houses fulfilling all the amenities required for a comfortable, convenient and happy living at most sought after location. AASHRAY is so designed for the comfort of its residents, conveniently located in terms of availability of transport facilities and proximity to the main city, industrial area, upcoming commercial hub, Dwarka Expressway and National Highway.

Homes





Specifications

- Flooring: Rooms: Ceramic Tiles, Kitchen: Ceramic Tiles, Toilet: Ceramic Tiles Balcony: Anti-Skid Ceramic Tiles, Common Area: Teracotta Tiles/Pavers/Stone/IPS Flooring
- Window Frame: MS Z-Section Frames as per IS Code
- Door Frame: Flush Doors painted with Flat Enamel Paints/Painted Hard Wood Frame Door
- Wall Tile: Bathroom: Ceramic Tiles upto 7 Feet in height. Kitchen: Ceramic Tiles upto 2 Feet in height above counter
- Kitchen Counter: Top: Terrazzo/Marble
- Wall Finish: Plaster with Oil Bond Distemper
- Toilets: PPR Pipes or equivalent. Chinaware & CP Fittings (ISI Marked)
- Electric Fittings ISI Marked & required electrical points
- MS Railing in Staircase and Balcony
- Structure : RCC Frames structure designed for SESMIC forces as per latest IS code and NBC guidelines.

Amenities

- Gated secured complex
- Community Hall
- Creche
- Kids Play area
- Convenient shopping
- Business centre
- Wifi facility
- 2 wheeler parking
- Visitor's Car parking
- Power Back up For common facilities





Type - 1 (2+1 BHK)
 Carpet Area : 645 Sq. ft.

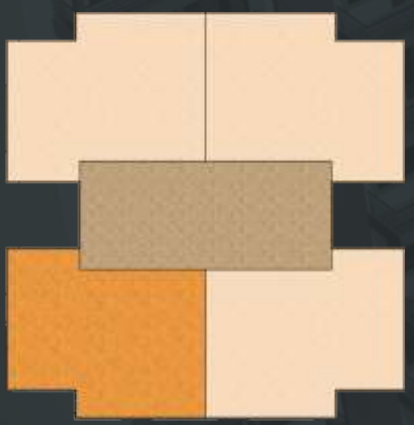
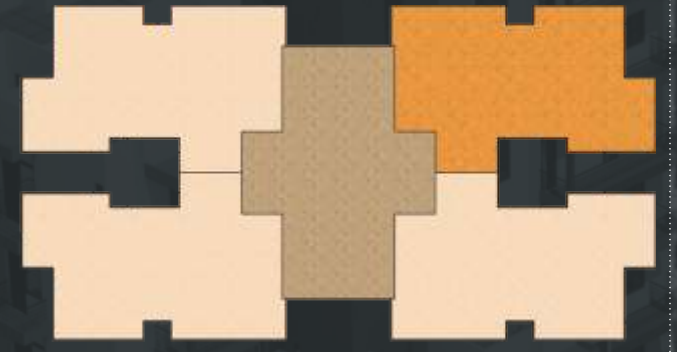

Type - 2 (2 BHK)
 Carpet Area : 593 Sq. ft.





Type - 3 (2 BHK)
Carpet Area : 518 Sq ft

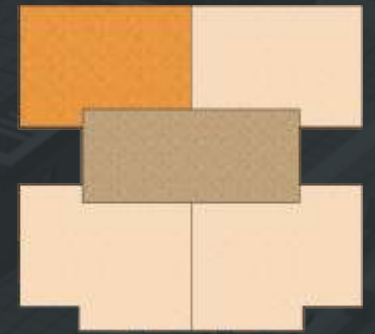

Type - 4 (2 BHK)
Carpet Area : 560 Sq ft

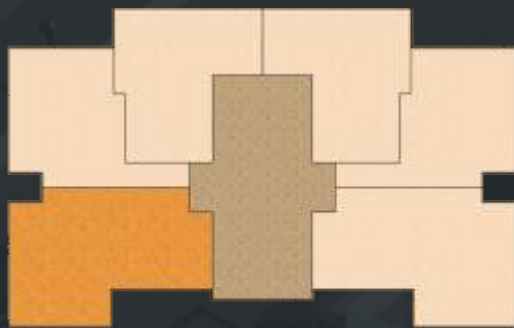



Type - 5 (1 BHK)
 Carpet Area : 419 Sq. ft.

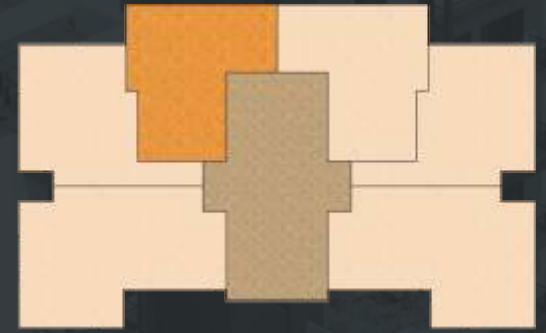

Type - 6 (1 BHK)
 Carpet Area : 401 Sq. ft.

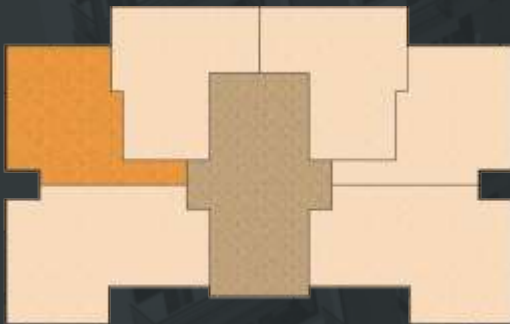



Type - 7 (1 BHK)
 Carpet Area : 397 Sq ft



Type - 8 (1 BHK)
 Carpet Area : 403 Sq ft

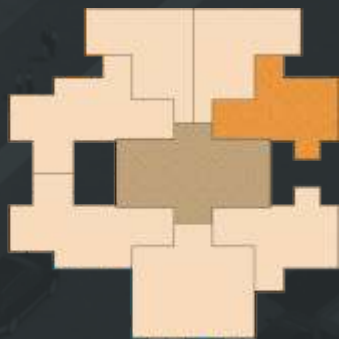

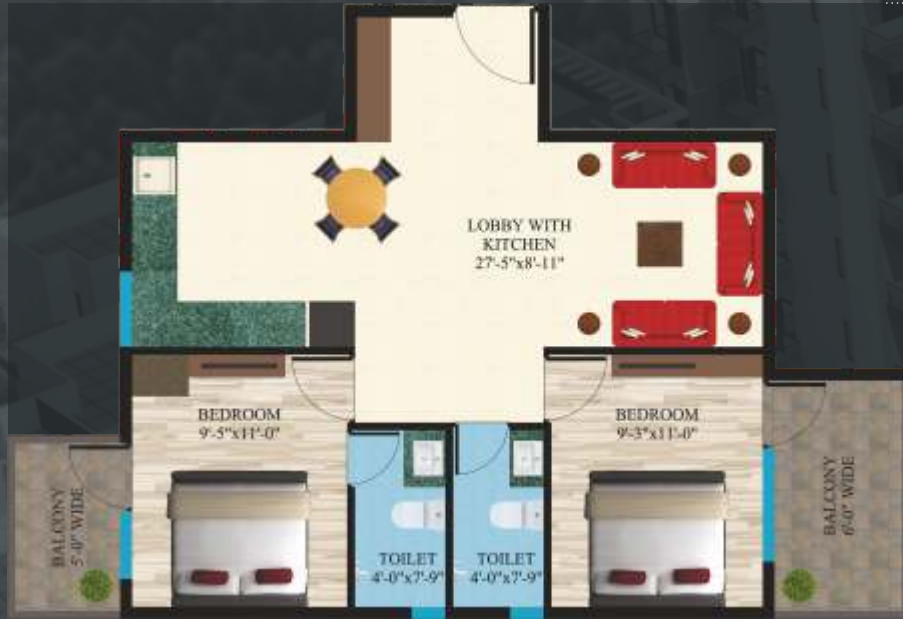

Type - 9 (2 BHK)
Carpet Area : 595 Sq. ft.

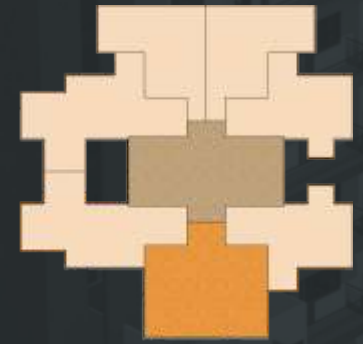

Type - 10 (2 BHK)
Carpet Area : 528 Sq. ft.





Type - 11 (2 BHK)
 Carpet Area : 492 Sq. ft.

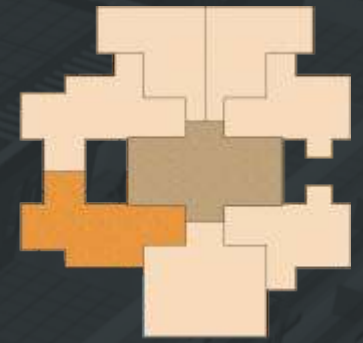

Type - 12 (2 BHK)
 Carpet Area : 511 Sq. ft.





Type - 13 (2 BHK)
Carpet Area : 590 Sq. ft.



Type - 14 (2 BHK)
Carpet Area : 553 Sq. ft.



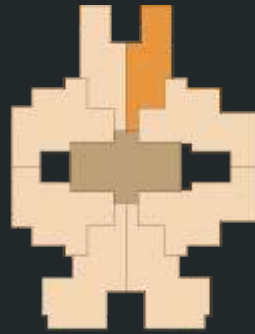

Type - 15 (1 BHK)
 Carpet Area : 404 Sq. ft.

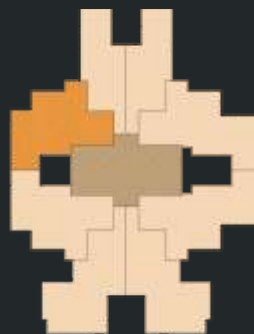

Type - 16 (2 BHK)
 Carpet Area : 593 Sq. ft.

Type - 17 (1 BHK)
Carpet Area : 406 Sq. ft.



Type - 18 (1 BHK)
Carpet Area : 446 Sq. ft.





Type - 19 (2 BHK)
 Carpet Area : 575 Sq. ft .

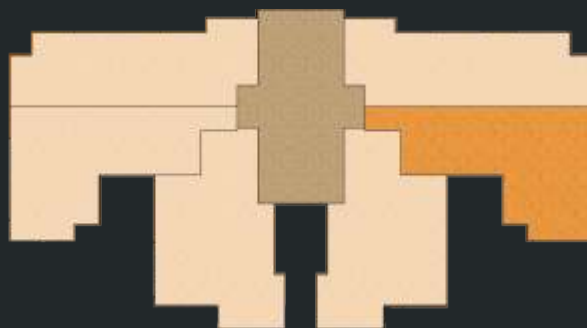
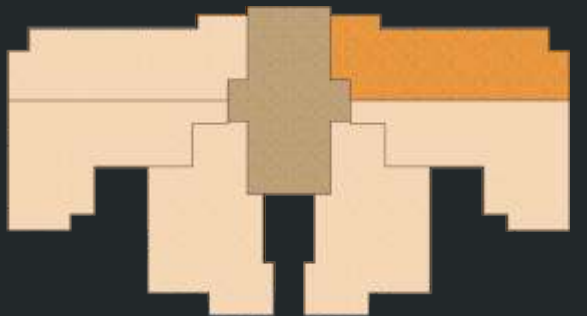

Type - 20 (2 BHK)
 Carpet Area : 606 Sq. ft .



Type - 21 (2+1 BHK)
 Carpet Area : 627 Sq. ft.



Type - 22 (2 BHK)
 Carpet Area : 610 Sq. ft.



Details of Apartment Sizes and Cost

S.No.	TYPE	No. of Apartments	Apartments Carpet Area	Balcony Size Per Apartments	Total Cost Per Apartments	(5%) Booking amount	(20%) on allotment	Balance 75% Amount
1	2+1 BHK	23	644.76 sq. ft.	100.00 sq. ft.	26,29,040.00	1,31,452.00	5,25,808.00	19,71,780.00
2	2 BHK	172	593.10 sq. ft.	100.00 sq. ft.	24,22,400.00	1,21,120.00	4,84,480.00	18,16,800.00
3	2 BHK	20	517.75 sq. ft.	100.00 sq. ft.	21,21,000.00	1,06,050.00	4,24,200.00	15,90,750.00
4	2 BHK	17	559.62 sq. ft.	100.00 sq. ft.	22,88,480.00	1,14,424.00	4,57,696.00	17,16,360.00
5	1 BHK	20	418.93 sq. ft.	100.00 sq. ft.	17,25,720.00	86,286.00	3,45,144.00	12,94,290.00
6	1 BHK	17	400.64 sq. ft.	94.94 sq. ft.	16,50,030.00	82,501.50	3,30,006.00	12,37,522.50
7	1 BHK	32	397.19 sq. ft.	100.00 sq. ft.	16,38,760.00	81,938.00	3,27,752.00	12,29,070.00
8	1 BHK	26	403.11 sq. ft.	100.00 sq. ft.	16,62,440.00	83,122.00	3,32,488.00	12,46,830.00
9	2 BHK	27	595.36 sq. ft.	100.00 sq. ft.	24,31,440.00	1,21,572.00	4,86,288.00	18,23,580.00
10	2 BHK	16	528.19 sq. ft.	60.39 sq. ft.	21,42,955.00	1,07,147.75	4,28,591.00	16,07,216.25
		8		100.00 sq. ft.	21,62,760.00	1,08,138.00	4,32,552.00	16,22,070.00
11	2 BHK	27	492.24 sq. ft.	38.43 sq. ft.	19,88,175.00	99,408.75	3,97,635.00	14,91,131.25
12	2 BHK	3	510.75 sq. ft.	100.00 sq. ft.	20,93,000.00	1,04,650.00	4,18,600.00	15,69,750.00
13	2 BHK	14	589.65 sq. ft.	70.50 sq. ft.	23,93,850.00	1,19,692.50	4,78,770.00	17,95,387.50
		37		100.00 sq. ft.	24,08,600.00	1,20,430.00	4,81,720.00	18,06,450.00
14	2 BHK	28	553.48 sq. ft.	67.17 sq. ft.	22,47,505.00	1,12,375.25	4,49,501.00	16,85,628.75
15	1 BHK	56	403.65 sq. ft.	100.00 sq. ft.	16,64,600.00	83,230.00	3,32,920.00	12,48,450.00
16	2 BHK	56	592.77 sq. ft.	79.98 sq. ft.	24,11,070.00	1,20,553.50	4,82,214.00	18,08,302.50
17	1 BHK	8	406.23 sq. ft.	98.71 sq. ft.	16,74,275.00	83,713.75	3,34,855.00	12,55,706.25
18	1 BHK	5	445.63 sq. ft.	100.00 sq. ft.	18,32,520.00	91,626.00	3,66,504.00	13,74,390.00
19	2 BHK	28	574.79 sq. ft.	100.00 sq. ft.	23,49,200.00	1,17,460.00	4,69,840.00	17,61,900.00
20	2 BHK	56	605.80 sq. ft.	100.00 sq. ft.	24,73,200.00	1,23,660.00	4,94,640.00	18,54,900.00
21	2 +1BHK	56	627.11 sq. ft.	77.82 sq. ft.	25,47,350.00	1,27,367.50	5,09,470.00	19,10,512.50
22	2 BHK	14	609.78 sq. ft.	100.00 sq. ft.	24,89,120.00	1,24,456.00	4,97,824.00	18,66,840.00

Payment Terms

- (i) With application: Booking amount i.e., 5% of cost of Apartment.
- (ii) On allotment: Additional 20% of cost of Apartment.
- (iii) Balance 75% of the amount in six equal installments over a period of three (3) years. No interest shall fall due before the due date of payment. Any default in payment shall invite interest at the rate of 15% per annum on delayed period.

Location Plan

The project is strategically located on the main Pataudi Road.(State Highway) in Sector 89 Gurgaon, Haryana.

Distance from major landmarks

Rajeev Chowk Gurugram	12 kms
Dwarka Expressway crossing	2 kms
National Highway 8	6 kms
Gurugram ISBT	10 Kms
Manesar IMT	4 kms

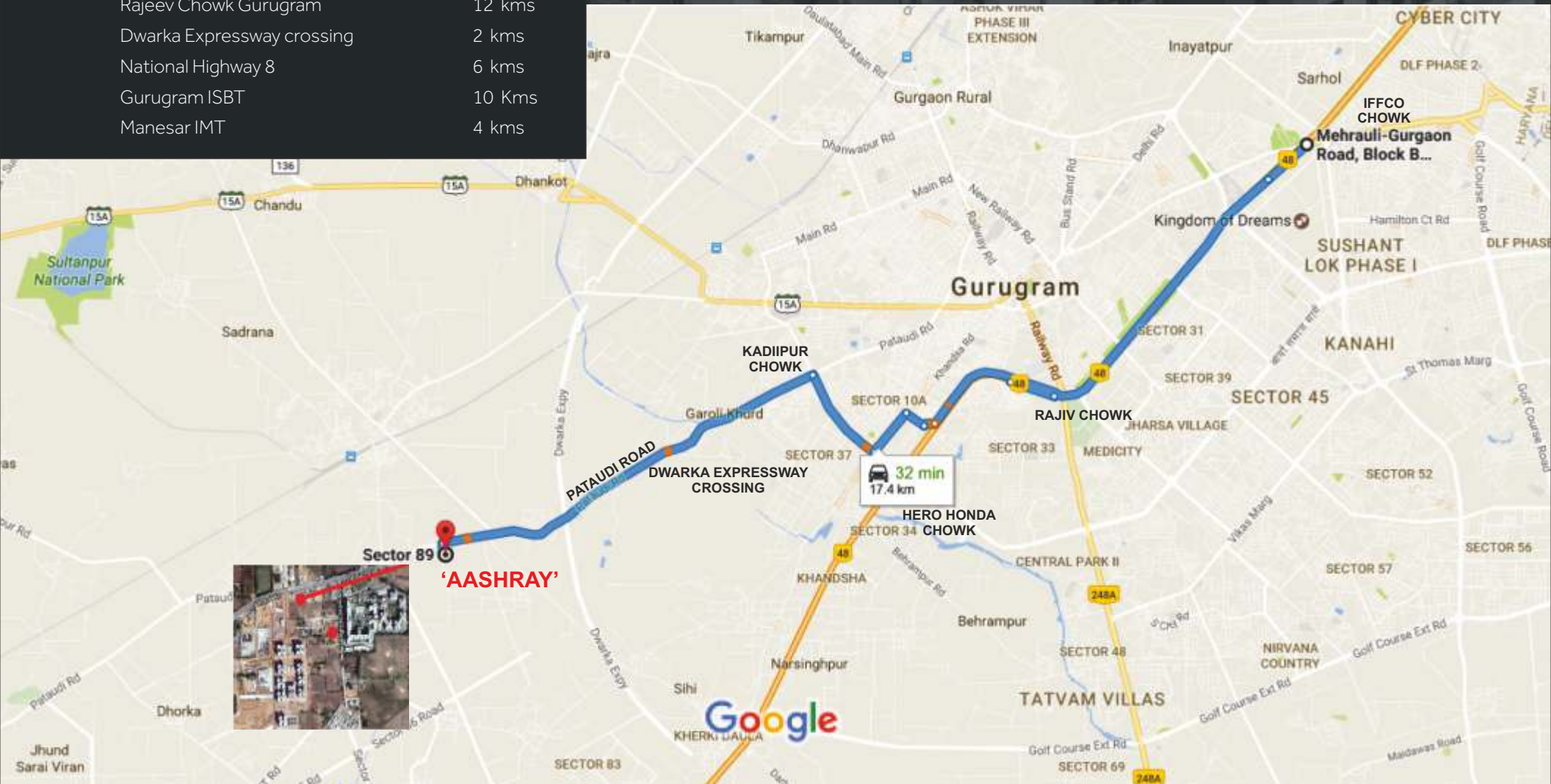

Site Plan



66 KV
H.T. LINE

POCKET D

POCKET C

POCKET A

POCKET B

24.00 MT. WIDE ROAD

24.00 MT. WIDE ROAD

24.00 MT. WIDE ROAD

13.41 MT. (44'-0") WIDE ROAD

3.35 MT. (11'-0") WIDE REVENUE ROAD

3.35 MT. (11'-0") WIDE REVENUE ROAD

12.00 MT. WIDE SERVICE ROAD

12.00 MT. WIDE SERVICE ROAD

18.00 MT. WIDE GREEN BELT

18.00 MT. WIDE GREEN BELT

75.00 MT. WIDE ROAD



AASHRAY AMENTIES



Kids Play Area



Landscape Garden/Park



Open Space



Firefighting Equipment



Video Security



Multipurpose Hall



Power Backup for common Facilities



Sewage Treatment Plant



MAXWORTH

Building Values in Real Estate

Maxworth Infrastructures Pvt. Ltd,

F - 30 - 31, 1st Floor, MGF Megacity Mall, M. G. Road, Gurugram, Haryana -122002

Tel. : +91-124-4222054, 55, 56 E mail. : sales@maxworth.co.in

www.maxworth.co.in

Application Form Cost Rs. 1000/-

Note: Visual representation shown in this brochure are conceptual and imaginative.